









Ortsplanung Gemeinde Kirchenturnen

Zonenplan

Massstab 1 : 2000

Bildet zusammen mit dem Baureglement die
Baurechtliche Grundordnung der Gemeinde

Legende

	ZPP	"Stockere Süd"
	W2	Wohnzone (2 Geschosse)
	K	Kernzone
	FF	Freifläche
	LWZ	Landwirtschaftszone
		Ortsbildschutzperimeter
		Wald
		Gemeindegrenze
		Naturobjekte geschützt (Bäume, Baumgruppen, Untergehölz etc. Art. 32 BR)

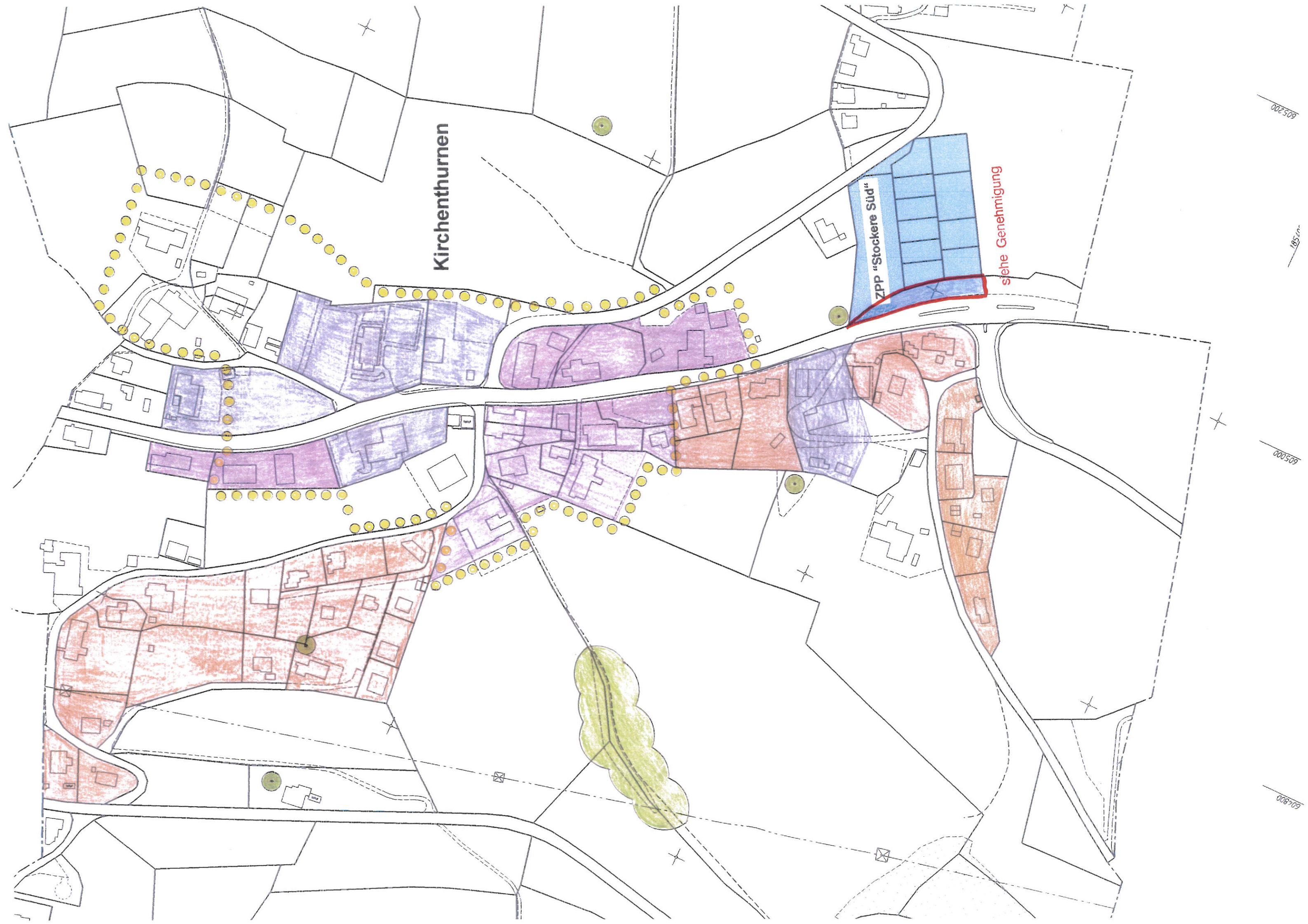

Kirchenthurnen

ZPP "Stockere Süd"

siehe Genehmigung

605/200

185/00

605/200

608/00